



Flat 1 20 Anerley Park

London, SE20 8ND

Asking Price £325,000

Set within an imposing and attractive four-storey Victorian building, this beautifully presented one-bedroom conversion flat offers a perfect blend of period charm and contemporary style. Boasting its own private front door, this characterful home occupies a generous 56.4 square metres of internal space.

Highlights include elegant stripped and varnished floorboards, a stylish modern bathroom suite, and well-proportioned rooms throughout, ideal for first-time buyers or those seeking a unique and charming property in a well-connected location.

Situated on the sought-after Anerley Park, this property is perfectly located for commuters and lifestyle seekers alike. Anerley Station is just a short walk away, offering swift links into London via Overground and Southern Rail services. You're also within easy walking distance of the vibrant Crystal Palace Triangle, known for its independent cafes, bars, and boutiques.

For outdoor enthusiasts and those who enjoy a weekend stroll, the ever-popular Crystal Palace Park is nearby, offering acres of green space, lakes, a maze, and the iconic dinosaurs.

Share of Freehold
Service charge - £200 per month
Bromley Council

Viewing

Please contact our Galloways Penge Office on 020 8778 1120 if you wish to arrange a viewing appointment for this property or require further information.

- ATTRACTIVE BUILDING
- TOTAL SQUARE FOOTAGE 56.4 SQm
- SHARE OF FREEHOLD
- STYLISH BATHROOM SUITE
- GARDEN
- STRIPPED AND VARNISHED FLOORBOARDS
- OWN FRONT DOOR
- 6 MINUTES WALK TO ANERLEY STATION
- 5 MINUTES WALK TO CRYSTAL PALACE PARK
- (WALKING TIMES ESTIMATED BY GOOGLE MAPS)

Floor Plan

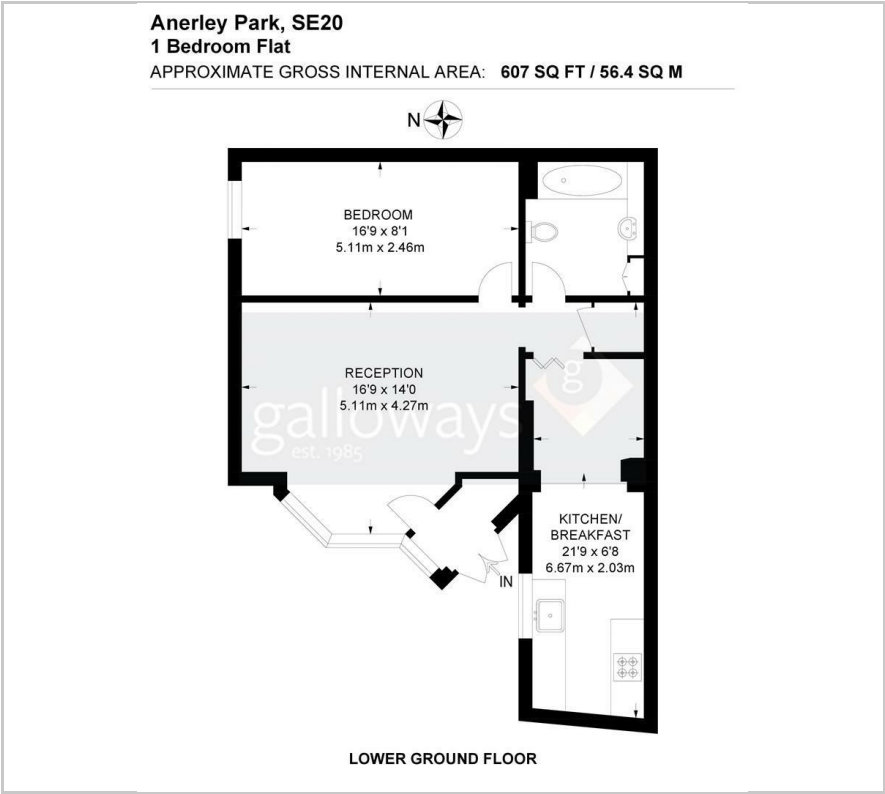

Area Map



Energy Efficiency Graph

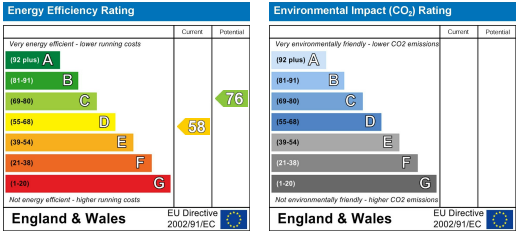

These particulars, whilst believed to be accurate are set out as a general outline only for guidance and do not constitute any part of an offer or contract. Intending purchasers should not rely on them as statements of representation of fact, but must satisfy themselves by inspection or otherwise as to their accuracy. No person in this firms employment has the authority to make or give any representation or warranty in respect of the property.